

Parlor



SCALLOP FINIAL
4.25"L 4"H



OXFORD FINIAL
4.5"L 3"H



SHERATON FINIAL
6"L 4"H



PINECONE FINIAL
5.75"L 3"H



WILLIAMSBURG
FINIAL
4.25"L 3"H



FLORETTE FINIAL
3.25"L 4"H



STANDARD AND
EXTENDED BRACKET
Standard bracket projects 4"
Extended bracket projects 6"



RINGS
2.5" Diameter

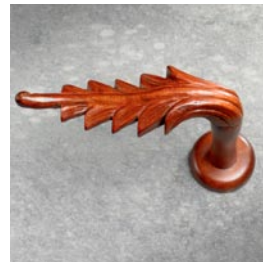

LEAF TIEBACK
7" Projection
7.75"L 2.25"H

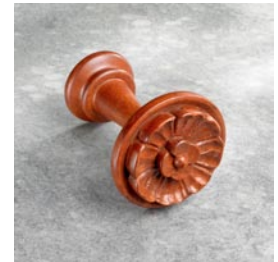

ROSETTE TIEBACK
5" Projection 3.5" Diameter

AVAILABLE FINISHES



CHESTNUT



MAHOGANY



OAK



UNFINISHED



CHERRY

ROBERT ALLEN

DRAPERY HARDWARE

HARDWARE FEATURES

- Premium Traverse System Features:
 - Premium single track, center-draw traverse rod systems are available as hand-draw and corded systems with or without c-rings in both 4' and 8' lengths.
 - Heavy-duty aluminum tracks are of the highest quality.
 - Superior strength performance. Maximum fabric weight: 6 pounds per foot.
 - Tracks are powder-coated inside and out in a brown finish, and sealed with a factory-applied dry-lubricant. This patented finishing technique allows for smooth operation and effortless glide of drapery across the rod.
- All hardware is hand-carved.
- Select styles are available in unfinished: Pinecone finial, Scallop finial, Sheraton finial, Rosette tieback, standard bracket, fluted rod (4' and 8'), and rings.
- Due to the variety of wood types used, variation in the wood coloration of the unfinished piece is apparent.
- We recommend painting as opposed to staining, as painting allows for more consistent coverage.
- Hand-finishing creates color variation that is to be expected and appreciated; it is part of the inherent beauty of this collection.

Parlor

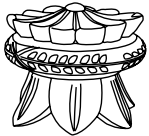

1



2

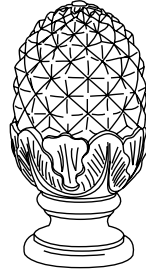

3

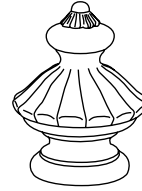

4



5

FINIALS

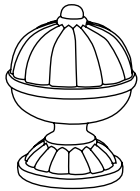

6



7

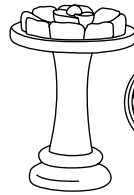

8

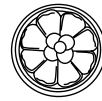

TOP DETAILS

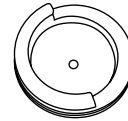

9

TIEBACKS

BRACKETS



10



11

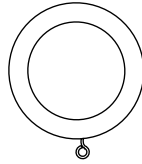

12



13

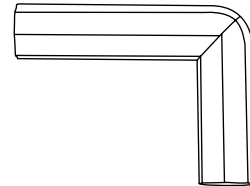

14

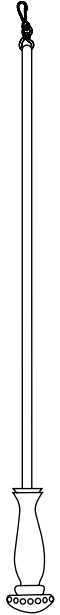

15

BRACKETS

OTHER

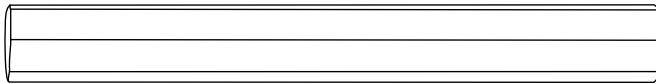

16

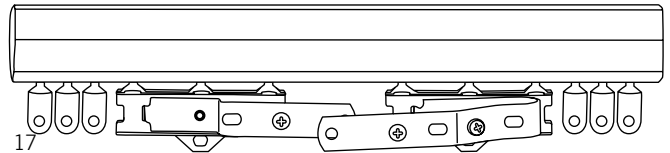

17

RODS

FINIALS

- 1 Florette finial, 2" (3.25"L 4"H)
- 2 Oxford finial, 2" (4.5"L 3"H)
- 3 Pinecone finial, 2" (5.75"L 3"H)
- 4 Scallop finial, 2" (4.25"L 4"H)
- 5 Sheraton finial, 2" (6"L 4"H)
- 6 Williamsburg, 2" (4.25"L 3"H)

TIEBACKS

- 7 Leaf tieback (7" extension 7.75"L 2.25"W)
- 8 Rosette tieback (5" extension 3.5" diameter)

BRACKETS

- 9 Inside Mount (2.75" diameter)
- 10 Standard bracket (4" projection)
- 11 Extended bracket (6" projection)

NOT SHOWN: 3" Traverse rod system brackets (2.5" projection)

OTHER

- 12 Ring (2.5" diameter)
- 13 C-rings (2.5" diameter)
- 14 2" fluted elbow (8"L 6"W)
- 15 Wand (36"L)

RODS

- 16 2" fluted rod (available in 4' and 8' lengths)
- 17 2" fluted traverse rod* (available in 4' and 8' lengths)

Premium center draw systems. Hand-draw or corded traverse systems with or without c-rings. *See pricelist for further details on traverse systems.

To adjust rod length, please follow general installation instructions for shortening wooden rods.

ROBERT ALLEN
 DRAPERY HARDWARE

For customer service call:
 US 800.333.3777
 CANADA 800.363.3020
 EUROPE +44 (0) 1494 414741