

swarovski

garda s, consul



Garda S black
polished nickel



Garda S clear
polished nickel



Consul
polished nickel



Swarovski rings



Swarovski holdback, flat



Swarovski holdback, round

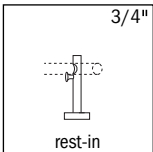

3/4" Pictured bracket is available in single or double format. Pass through brackets are only available when used in combination with standard rest-in brackets.



available rod diameter

ROBERT ALLEN

PRESENTS

B L M E

swarovski

garda s, consul measurements

finials

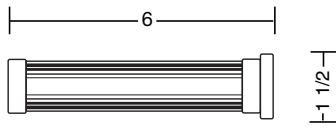

garda S

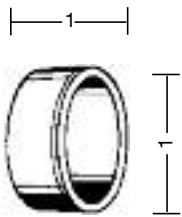

consul

holdbacks

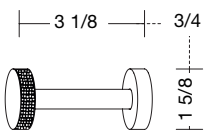

Swarovski holdback, round

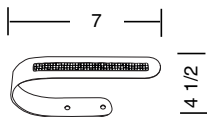

Swarovski holdback, flat

brackets

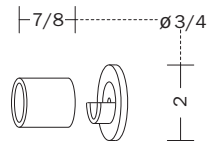

inside mount bracket

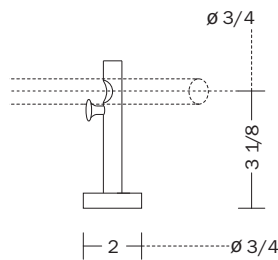

rest-in bracket

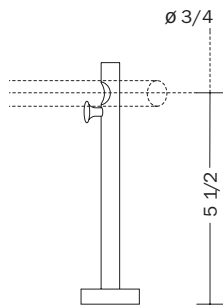

rest-in bracket extended

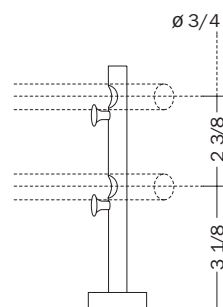

double rest-in bracket

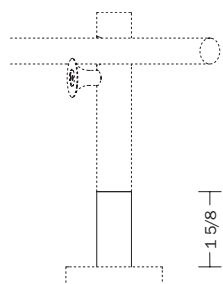

bracket extender (for rest-in bracket)

brackets

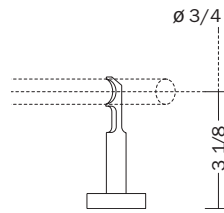

pass-through bracket

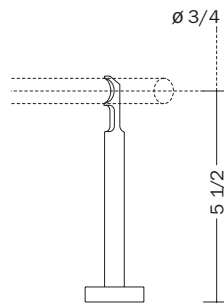

pass-through bracket extended

accessories

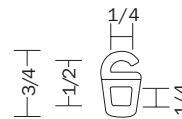

eyelet hook

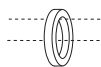

Swarovski and standard ring



c-ring

∅ = diameter of rod

All measurements above are listed in inches

ROBERT ALLEN

PRESENTS

B L M E